



**Enterprise class A4 MFPs designed for seamless integration into your document workflow**

PRINT COPY SCAN FAX<sup>1</sup> FINISHER



A4	✓
Colour/Mono	✓
Duplex print, copy, scan, fax <sup>1</sup> , finishing	✓
sXP - smart Extendable Platform	✓
1 - 30+ users	✓



MB760  
MB770  
MC760  
MC770  
MC780



# Advanced technology that lets you take control of your document workflow

A4 mono and colour MFPs that maximise productivity whilst delivering efficiency at many levels of your organisation.

Improving the way that documents are handled, managed and processed through an organisation can deliver significant workflow efficiencies at every level.

A combination of sophisticated software with advanced technology enables organisations to enhance productivity and improve their document input, throughput and output. The MB700 and MC700 Series of multifunction products (MFPs) provide seamless integration with existing systems by using our sXP (smart Extendable Platform). They provide the tools you need to ensure the efficient use of resources

within your organisation, whilst improving communication and document workflow throughout.

Combining print, copy, scan, fax<sup>1</sup> and stapling functionality in one high speed, ergonomic device, the MB700 and MC700 Series offer efficient and secure document management and output that is suited to organisations of all sizes, from large corporate multinationals and financial institutions to educational establishments and SMBs. With a range of models and accessories available you can select the MFP that meets your specific needs and budget.



## sXP (smart Extendable Platform) at the heart of your business productivity

The MB700 and MC700 Series come with sXP, an open platform to help streamline your document intensive business processes.

This web services based platform enables seamless integration of these MFPs with your bespoke system or 3rd party solutions, for example, PaperCut MF and Drive Image. This ensures that your document capture, distribution, management and output is efficiently executed and implemented, improving the productivity of your staff.

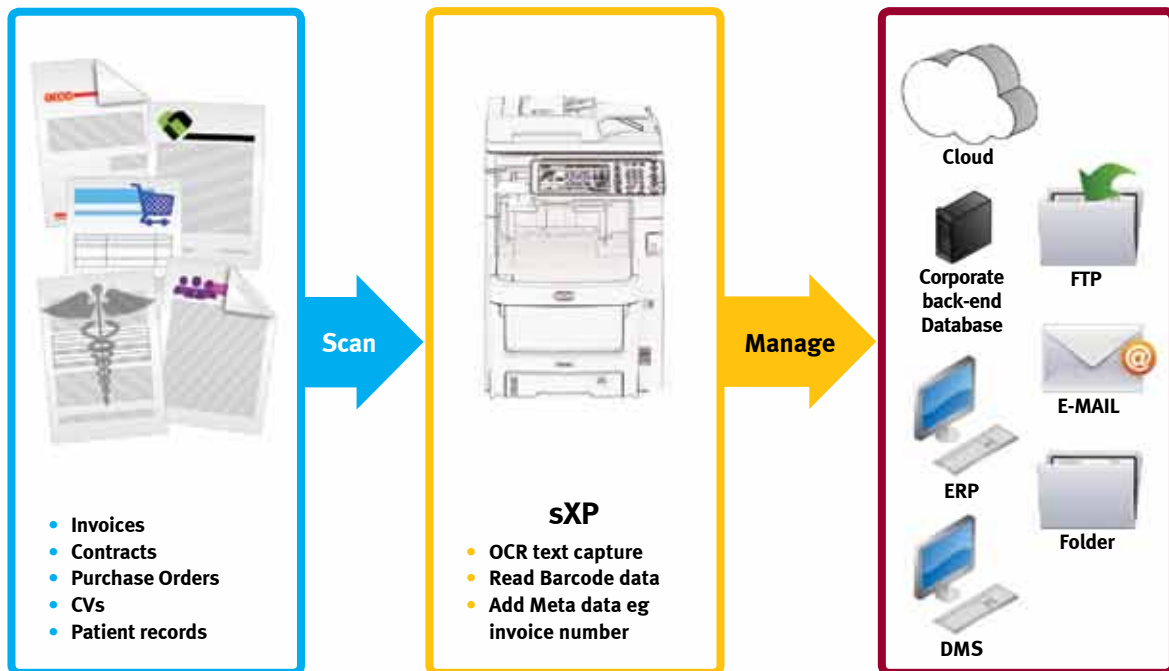

# A smart new range of A4 MFPs from OKI – the centre of your document workflow



## Flexibility

### Maximising your investment for ultimate flexibility

The MB700 and MC700 Series have been designed to deliver an extensive range of high value features as standard. These robust and efficient MFPs are available in 6 different models providing you with the flexibility you require to meet your business needs.

- Ability to connect to 3rd party software solutions for seamless network integration
- Customisable user interface for integration into your document workflow
- Select the model and accessories that meet your business needs



## Productivity

### Improving Business productivity

The MB700 and MC700 Series are built to perform. With high speeds and flexible finishing options these MFPs have in-built functionality to save end-user time, so they can focus on their core activities.

- 23cm colour backlit touch screen
- Up to 52ppm print speed in mono and up to 40ppm in colour
- Paper capacity of up to 3,160 sheets
- Internal finisher (dfn versions)
- Built-in convenience stapler as standard
- Up to 200k monthly duty cycle
- 1.2GHz processor and 2GB RAM memory
- Standard 320GB HDD
- 10/100/1000 baseT Ethernet
- Three year on-site warranty on registration of your product within 30 days

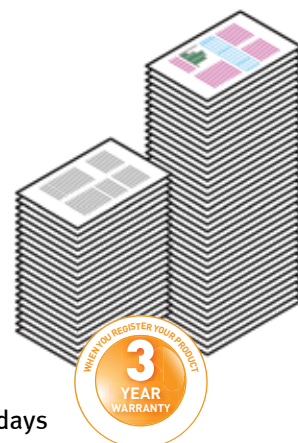

## Environment

### Reducing your impact on the environment

The MB700 and MC700 Series are the first full LED A4 medium to large workgroup MFPs on the market. OKI technology and in-built eco features ensure these are amongst the most environmentally friendly MFPs available.

- Full LED MFP (both scanner and printer)
- Duplex print, copy, scan and fax<sup>1</sup> for reduced paper usage
- High capacity toner cartridges
- Toner save function
- 2W or less Deep Sleep mode
- Energy Star certified
- Consumables recycling programme



## Security

### Highest level document and data security

IT security is a major concern for businesses today, which is why OKI offers security and encryption to the highest industry standards. Sophisticated user authentication prevents unauthorised access and protects your corporate data whilst user access can be customised, allowing you to enable or disable functions easily.

- IP/Mac filtering
- Hard disk encryption
- Secure print job encryption
- SNMPv3 and optional IPsec secure networking
- Secure erase for automatic, scheduled or manual HDD wiping
- PIN/IC Card/LDAP/Kerberos access control
- Secure print with PIN or with optional card reader (MIFARE/HID)



# Advanced features that help improve the

## Large colour touch screen

Customisable user interface that provides access to a range of standard and bespoke functions facilitated by sXP

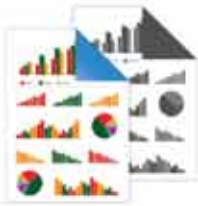

## Automatic LED duplex printing

Automatic duplex as standard, for cost effective printing of double-sided documents



## Wireless connectivity

Optional wireless functionality so that your MFP can be placed anywhere in the office



## Convenience stapler

Built-in convenience stapler as standard, for easy post production finishing

## Internal finisher\*

Automatic stapler combined with offset paper stacking and duplex printing for advanced document finishing



## Flexible paper capacity

Three optional paper trays or Large Capacity Feeder (LCF) available (up to 3,160 sheets), to suit your business needs



## High yield cartridges

Reduce user intervention, cost and impact upon the environment



## Duplex LED copying and scanning

Fast and accurate duplex copying and scanning, through 100-sheet RADF. For simple, efficient handling of double-sided documents



## Enterprise-wide security

Secure PIN or IC card release solutions for protected printing of confidential documents



# efficiency of your business



## High definition LED scanning

- Fast scan speed of up to 40ipm (MC780)/ 55ipm (MB770)
- 24bit colour / 8bit greyscale / bi-level mono
- Scanning resolution 600x600dpi
- Duplex scanning
- WSD, USB and network TWAIN scanning
- On-screen scan preview
- Save scan settings for repeated tasks
- Remote scanning to a number of networked PCs
- Scan to filing box, scan to shared folder, scan to email, scan to USB memory
- Blank page skipping

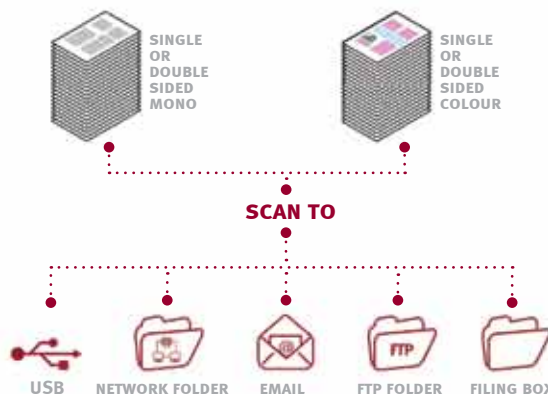

## Clearer and sharper copying



- Fast copy speeds of up to 40ppm (MC780)/ 52ppm (MB770)
- First copy out time 13 seconds (MC700 Series)/ 8 seconds (MB700 Series)
- Duplex copy (1 to 2, 2 to 1, 2 to 2)
- Background removal, edge erase, proof copy for best copy output
- ID Card copy, repeat copy, job build copy
- Cover sheet, sheet insertion mode
- N-up, collate, margin shift, trimming, masking, mirror image
- Job interrupt for urgent copying
- Department code, user code
- Job Macro stores frequent tasks



## Faster, high definition printing

- Fast print speeds of up to 40ppm (MC780)/ 52ppm (MB770)
- Time to first print 8 seconds colour/ 8 seconds mono (MC780), less than 5 seconds (MB700 Series)
- Print resolution 1200x600dpi (MC700 Series)/ 1200x1200dpi (MB700 Series)
- Duplex printing
- Flexible media handling (up to 250gsm and up to 1.3m banners)
- Offset stacking, stapling (dfn version)
- Encrypted secure print (private print, hold print, proof print)

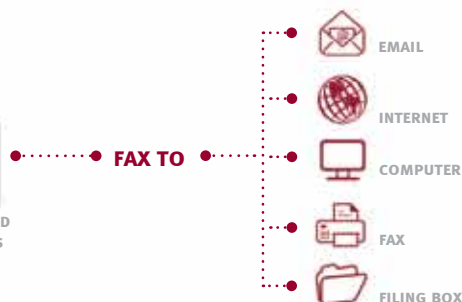

## Super G3 fax<sup>1</sup> with added functionality

- Super G3 faxing speed, 33.6kbps modem speed
- 3 seconds transmission time
- Send duplex document fax from RADF
- 1GB memory capacity
- Delayed transmission
- Fax forwarding (fax to fax and fax to email)
- PC fax, i-Fax

# Smart Software Solutions/Utilities

OKI provides a suite of software, offering added functionality, control and efficiencies for your business.

## Alidata

### Output Management

This powerful device management tool from Alidata is a scalable, vendor agnostic solution that enables organisations to centrally manage and optimise their print and copy workflow. It provides the ability to enforce rules, quotas and user notifications, resulting in cost management and higher levels of security across the business:

- pull printing and secure print release from any enabled device
- Universal Print Driver (driverless printing) – easy client deployment, default configuration set by the administrator
- scan to desktop (scan-to-me)
- secure device access through login authentication (PIN or ID Card)
- visibility and control of print and copy usage by user or department enforcing quotas (mono/colour) in real-time management
- customised print routing policies – enforcing the most cost effective device
- track print job and device status, consumables usage
- advanced administration console: dashboard, reporting, cost analysis and consumables.
- eliminate wastage and associated energy consumption

- automatic fault notification
- automatic meter reading
- automated consumables management
- high level reporting capabilities



### PrintSuperVision

For the management and control of networked printers and MFPs:

- manage devices and troubleshoot any problems
- monitor which printers require new toners before they run out
- limit user intervention maintaining productivity workflow
- provide complete control and visibility of all printers and MFPs across your network



### Print Job Accounting

Provides visibility and control of your organisation's print spend:

- visibility and control of print usage within your business
- restrict access to individuals and or groups
- manage printing within defined cost limits
- create reports on volume, paper size, media type
- view all data on a web page (Enterprise version)
- import users from an Active Directory (Enterprise version)
- supports SQL databases (Enterprise version)



### Fleet Management

A comprehensive vendor agnostic solution from PrintFleet for remote management and control of your printers and MFPs:

- online monitoring of your fleet of devices

## Select the model and accessories to meet your specific business needs

The MB700 and MC700 Series have been designed to provide complete flexibility and choice to meet your business needs. Select from a range of models and options including wireless connectivity, fax<sup>1</sup> operation, performance levels and paper trays.

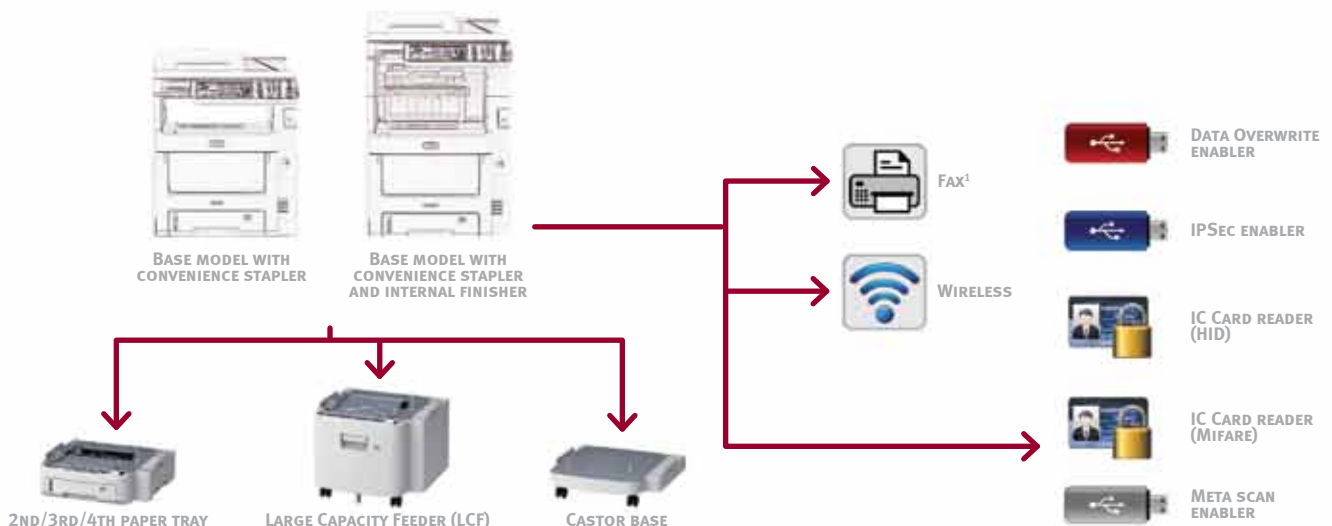



dn versions



dfn version  
(with internal finisher)



dn versions



dfn version  
(with internal finisher)

## Summary Specifications

	MC760dn	MC770dn	MC780dfn	MB760dn	MB770dn/dfn
<b>Printing</b>					
Print speed	28ppm colour; 28ppm mono	34ppm colour; 36ppm mono	40ppm colour; 40ppm mono	47ppm mono	52ppm mono
Function	Print, Copy, Scan, Fax <sup>1</sup>				
User interface	23cm Colour backlit LCD touch screen				
Time to 1st print	9 seconds colour, 8 seconds mono		8 seconds colour, 8 seconds mono		5 seconds mono
Print resolution	ProQ2400 Multi-level Technology, 1200 x 600dpi			1200 x 1200dpi	
Memory/ processor	2GB RAM/1.2GHz				
Hard Disk Drive	320GB				
Connectivity	10/100/1000 baseT, USB 2.0/ Hi Speed USB - Optional Wireless (802.11 b/g)				
Security	IP Filtering, MAC Filtering, IPSec(option), Secure Print, Secure print job encryption(by secure HDD), SMTP server authentication, POP before SMTP authentication, SSL Security for SMTP Protocol, SNMPv3, SSL/TLS Encryption, Port Change, Storage Devices entire Encryption, Secure Erase of storages, Disable Host USB feature				
Duty cycle (Average)	Up to 6,000 pages/month	Up to 8,000 pages/month	Up to 10,000 pages/month	Up to 20,000 pages/month	15,000 to 30,000 pages/month
Duty cycle (Maximum)	100,000 pages/month			200,000 pages/month	
<b>Copying</b>					
Copy speed	28ppm colour; 28ppm mono	34ppm colour; 36ppm mono	40ppm colour; 40ppm mono	47ppm mono	52ppm mono
Time to 1st copy	Less than 13 seconds			Less than 8 seconds	
<b>Scanning</b>					
Format	JPEG, TIFF(multi/single page), PDF(multi/single page), Slim PDF, Secure PDF, XPS(multi/single page)				
Scan speed	Up to 40ipm (colour/mono)			Up to 55ipm (mono)	
Scan to	SMB, FTP, FTPS, Netware, FilingBox, USB Memory, E-mail				
Optical scanning resolution	600 x 600dpi				
<b>Fax<sup>1</sup></b>					
Resolution	Up to 300dpi				
Fax speed	ITU-T G3(Super G3) up to 33.6kbps, 3 seconds/page				
<b>Paper Handling</b>					
Paper capacity	Tray 1: 530 sheets of 80gsm; MPT: 100 sheets of 80gsm; RADF: 100 sheets of 80gsm				
Paper capacity optional trays	Tray 2: 530 sheets of 80gsm; Tray 3: 530 sheets of 80gsm; Tray 4: 530 sheets of 80gsm; Large Capacity Feeder (LCF): 2000 sheets of 80gsm				
Input capacity	Standard: 630 sheets of 80gsm; Maximum: 3,160 sheets of 80gsm				
Paper output capacity	Up to 500 sheets of 80gsm				
Media weight	Tray 1/2/3/4/LCF: 64 to 220gsm; MPT: 64 to 250gsm				
Media size	A4, A5, B5, A6, Custom size up to 1321mm				
Finishing	Convenience stapler	Convenience stapler	Convenience stapler, Internal finisher	Convenience stapler	Convenience stapler, Internal finisher (dfn version)
Accessories	Wireless, IC Card Reader (HID), IC Card Reader (Mifare), Data overwrite, IPSec, Meta Scan				
<b>General features</b>					
Noise	Operating: 57dB(A); Standby: 37dB(A); Power save: Inaudible			Operating: 58dB(A); Standby: 30dB(A); Power save: Inaudible	
Power consumption	Typical: 800W; Max: 1500W; Idle: 130W; Power Save: 60W; Deep Sleep: 2W or less			Typical: 870W; Max: 1500W; Idle: 120W; Power Save: 40W; Deep Sleep: 2W or less	
Warranty	3 years extended warranty upon registration within 30 days of purchase				
Dimensions (HxWxD)	dn: 675 x 522 x 604mm; dfn: 811 x 522 x 604mm			dn: 675 x 522 x 564mm; dfn: 811 x 522 x 564mm	
<b>Consumables</b>					
Starter toner	4.8k (pages)			10k (pages)	
Toner (K)	8k (pages)	8k, 15k (pages)		18k (pages)	18k, 36k (pages)
Toner (CMY)	6k (pages)	6, 11.5k (pages)		-	-
Drum	30k (pages)			-	-
Transfer belt	60k (pages)			-	-
Fuser unit	60k (pages)			-	-

## Business Printing Specialists

OKI's printer division is a global business-to-business brand dedicated to creating cost effective, professional in-house printing solutions which are designed to increase the efficiency of today's and tomorrow's businesses and their workflows. As pioneers in innovative print technologies from digital LED to High Definition Colour, we have a portfolio of award winning products and solutions enabling businesses to achieve both image focused, vibrant, quality print communications and budget flexibility.

OKI presents a full range of A3 and A4 colour and mono printers and MFPs, for workgroups and businesses of all sizes with superior media-handling capabilities. In addition our fax, POS and dot matrix printers complete our range of print solutions. These best in class products are designed to be easy to use making the job of in-house print easier.



### Considering the Environment

As part of the OKI Group's Charter of Corporate Conduct, OKI continually reviews its efforts to provide environmentally sound solutions to its customers:

- Our products are designed and manufactured with reducing the impact on the environment in mind.
- Increasing the amount of our hardware products and consumables that are recycled is one of our strategic objectives.
- We feel responsible for conducting our business in an environmentally sound manner, contributing to conservation and activities within our local communities.

OKI's Green Leaf symbol, found on all products and packaging, represents our total commitment to collection, recycling and environmental processes.



### Energy Star

Our printers and MFPs have earned the Energy Star by helping to eliminate energy waste through particularly energy-efficient designs. They use less energy to perform regular tasks. When not in use, they automatically enter a powersave mode and product features such as, duplex printing, further reduce the wasting of energy and paper resources.



### 3 Year Warranty

Our devices are manufactured to the highest standards of quality and technology, which has been confirmed by independent tests. We are so convinced of the high quality of our products that we are offering you an extension of the standard warranty period to 3 years at no extra cost to you. Simply register your product within 30 days of purchase. For further information please visit: [WWW.OKIUSER.COM](http://WWW.OKIUSER.COM)



### 20 years of LED Technology

OKI pioneered the development of digital LED technology in printers over 20 years ago. This innovation delivers High Definition printing – for more accurate, striking printed documents. Thanks to this digital LED technology, our printers are compact, environmentally friendly and energy efficient, using significantly less raw materials in the manufacturing process and consuming less energy. LED print heads have no moving parts, making our LED printers robust and ultra reliable.

Scan here  
to find out more



#### OKI EUROPE LTD

Blays House, Wick Road,  
Egham Surrey, TW20 0HJ,  
UK

T +44 (0)20 8219 2190

F +44 (0)20 8219 2199

[WWW.OKI.COM/EU](http://WWW.OKI.COM/EU)

# OKI

Open up your dreams