

Epson EcoTank ET-M1100



[+ ENLARGE IMAGE](#)

EcoTank Single Function Printers

[Printer Friendly Specs](#)

[Where to Buy](#)

Overview

Introducing the revolutionary new EcoTank Monochrome printer.

The ET-M1100 Single Function Printer with integrated ink tank system is ideal for busy homes looking to cut their printing costs. Thanks to the integrated high-capacity ink tank, ink is supplied continuously to the printer, so there are no cartridges to replace; you simply top up the tank with the Epson ink bottle and keep on printing.

KEY FEATURES & BENEFITS

- Cartridge Free Printing – integrated high capacity ink tank system.
- 2 Years of ink included¹ – Freedom to print up to 5,000 pages in black.²
- Extremely Low Cost Per Page – with replacement ink bottle.
- Low-cost replacement ink bottle – and easily refillable ink tank with replacement ink bottle.
- Fast First Page out Time – in only 8 seconds.
- Small size, great performance – save space at home.
- Bonus 1 year warranty – upon registration within 30 days³.

PRINTING FREEDOM

For one upfront price, the Epson EcoTank printers come with enough ink in the box to print for up to 2 years¹, so you can print up to 5000 pages in black without worrying about ongoing ink replacement and costs.



HIGH-VOLUME INK BOTTLE

Additional low-cost ink can be bought in a convenient high-volume bottle that has a drip-free nozzle and resealable cap for easy storage and refilling. We have redesigned our ink bottles to incorporate a unique key system to ensure more precise refilling to avoid spillage. The ink bottle also incorporates a pressure mechanism so the bottle automatically stops exerting ink once the ink tank is full. Replacement bottles hold enough ink for a massive 6,000 pages in black².

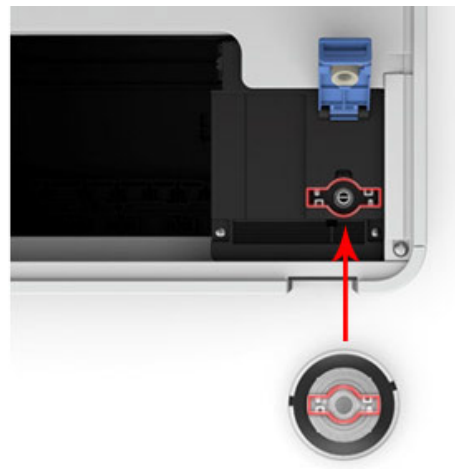

SPACE SAVING DESIGN

The ET-M1100 is designed for small spaces. Its compact footprint means you can fit it comfortably anywhere in your home or home office, creating an ergonomic work environment.



REGISTRATION OFFER

The Epson ET-M1100 is backed by a 2 year Return-to-Base warranty (1 year standard and a bonus 1 year upon registration).

Receive your additional 1 year bonus warranty when you register online³ at www.epson.com.au/registrations within 30 days of purchase providing a total of 2 Years Warranty.

¹ 2 years' of ink based upon user's average monthly print volume (200 pages per month.)

² Quoted yields are extrapolated based on Epson original methodology from the print simulation of Test Patterns provided in ISO/IEC 19752. Quoted yields are NOT based on ISO/IEC 24711. Quoted yield may vary depending on the images that you are printing, the paper type that you are using, the frequency of your prints and environmental conditions such as temperature.

³ 12 months of standard Return to Base warranty. For an additional 12 months (making a total of 24 months), you must register on www.epson.com.au/registrations within 30 days of purchase.

Specification

Printer

PRINTER TYPE

EcoTank ET-M1100	C11CG95509
PRINTING METHOD	On-demand Inkjet (piezoelectric)
NOZZLE CONFIGURATION	180 x 2 nozzles Black
MINIMUM INK DROPLET VOLUME	3 Picolitres

WHAT'S IN THE BOX

- ET-M1100 EcoTank Printer
- Instruction manual
- CD-ROM for product setup
- Power cord
- USB cable not included (Optional extra)
- Initial ink bottle: Black (T532)

RESOLUTION

1440 x 720

PRINT SPEED

BLACK TEXT (MEMO) A4

15.0 ISO ppm¹**PAPER HANDLING**

PAPER SIZES

A4, Letter, Legal, A6, A5, B5, B6, 8.5x13", Executive, Half Letter. Envelopes: No10, DL, C6

PAPER HOLD CAPACITY

Input capacity: 150 sheets, A4 Plain paper (64-90g/m²)**General****OPERATING SYSTEMS**

PRINTER DRIVERS*

Windows XP SP3 or later (32-bit), Windows XP Professional x64 Edition SP2 or later /Vista/7/8/8.1/10

MAC OS X 10.6.8, 10.7.x, 10.8.x, 10.9.x, 10.10.x, 10.11.x, 10.12.x, 10.13.x

ELECTRICAL SPECIFICATIONS

RATED VOLTAGE

AC 100 ~ 240V

RATED FREQUENCY

50 ~ 60Hz

NOISE LEVEL

NOISE LEVEL #

6.6B
53db

According to ISO7779 Pattern with Plain Paper

INTERFACES

CONNECTIVITY

High Speed USB — Compatible with the USB Specification.

NETWORKING

-

MOBILE DEVICE PRINTING

-

LCD SCREEN

No

WARRANTY

12 months return to base

Standard

Epson WarrantyFor an additional 12 months (making a total of 24 months), you must register on www.epson.com.au/register_product/ within 30 days of purchase.**PRODUCT DIMENSIONS**

375mm (W) x 267mm (D) x 161mm (H)

WEIGHT

3.5kg

INK Bottle

T532

Black

INK BOTTLE YIELDS²

Approx. Black 6,000 pages

¹Black print speeds are measured in accordance with ISO/IEC 24734. Actual print times will vary based on system configuration, software, and page complexity. [Click here for details on ISO testing.](#)

² Quoted yields are extrapolated based on Epson original methodology from the print simulation of Test Patterns provided in ISO/IEC 19752. Quoted yields are NOT based on ISO/IEC 24711. Quoted yield may vary depending on the images that you are printing, the paper type that you are using, the frequency of your prints and environmental conditions such as temperature.

Warning to Epson printer owners. Many well known third party companies claim their inkjet printing papers are compatible with all Epson inkjet printers. Epson has reports from many customers who have used third party paper and have been very disappointed with the results. When the same customers have changed to genuine Epson paper, they have been amazed and pleased with the colour and quality of their prints. Epson recommends that you do not use any non genuine printing papers if you want to get the best results from your Epson printer. Epson printers are very carefully tuned to ensure Epson inks and Epson's patented MicroPiezo™ printhead produce the best quality prints using carefully selected Epson paper.

All other brands of printing papers are not wholly compatible with the printer.

Equipment supplied by Epson Australia is designed to function in conjunction with genuine Epson consumables and accessories specifically configured for it.

Usage Conditions

Epson products are designed and made to give highly reliable use and long life when used according to its specifications. With any system, product or device used in situations where human life may be involved or at risk, Epson advises that you should take all necessary steps to ensure the suitability of your Epson product for inclusion in your system, and recommends that you include fail-safe procedures and redundancy support or backup equipment in your system, to maintain the maximum safety margin and optimum system reliability. Examples include but are not limited to – do not interfere with any electrical components within the device, do not use items supplied with the product for purposes other than as intended by Epson (ie mains cords, inks, CDs, plastic wrapping) and do not make modifications to the product.

Consumables

GENUINE Epson PAPERS	PRODUCT CODE
<u>A4 Double-Sided Matte Paper - 50 Sheets (178gsm)</u>	S041569
<u>A4 Matte Paper Heavy Weight - 50 Sheets (167gsm)</u>	S041256
<u>A4 Photo Quality Inkjet Paper - 100 Sheets (102gsm)</u>	S041061

INK CARTRIDGES	PRODUCT CODE
<u>T532 - EcoTank - Black Ink Bottle</u>	T033192

ACCESSORIES & OPTIONS	PRODUCT CODE
<u>USB 2.0 Cable Type A to B - 2m</u>	USB2M31645
<u>USB 2.0 Cable Type A to B - 5m</u>	USB5M31647

Epson is the registered trademark of Seiko Epson Corporation. Epson STYLUS, PerfectPicture, MicroPiezo, AcuPhoto Halftoning, QuickDry are the trademarks of Seiko Epson Corporation. All other names and company names used herein are for identification purpose only and may be the trademarks or registered trademarks of their respective owners. Epson disclaims any and all rights in those marks. All print samples shown herein are imulations. Specifications are subject to change without notice.